



Endless Choices, Simply You.

Kitchens



Bathrooms



Furniture



Species



Alder

Grown in the Pacific Northwest, Alder is processed and graded for a slightly darker and more consistent rich color, which is desired by most designers, builders and buyers. Alder is also known to hold and absorb stains and finishes wonderfully!



One word to describe wood from the cherry tree....Incredible! The rich reds and browns grow deeper with age while small dark specks add to its intriguing look and definition. Rustic Cherry has more pitch, mineral, sapwood and heartwood color variations with larger knots.

Cherry



Hickory

Hickory is a very dense and shock resistant wood. Aside from its durability, Hickory is also very beautiful. With an array of color ranging from soft white to rustic black your cabinets are sure to be one of a kind!



Grown in an ideal climate where soil conditions and genetic history of the species result in some of the finest Soft Maple in the United States. Maple is a hardwood with a naturally lighter color than the other species we offer. It also accepts stains and finishes beautifully.

Maple



Oak

Oak is a classic beauty that boasts a durable shock resistance as well as the ability to retain stains and finishes. The large, grainy texture of oak makes it the perfect species for added character.
Available in Red And White Oak



Walnut is one of nature's biggest accomplishments. With an array of color ranging from a light brown to a rustic black you can be sure that your Walnut cabinets will have a very unique look.

Walnut



Paint Grade

High quality, paint ready HDF (High Density Fiberboard) is the ideal species for solid colors as you will not need to worry about the expansion and contraction that comes with natural hardwoods.



Laminate



Looking for a modern look with crisp lines to brighten your space? Look no further than a Textured Laminate door on a European cabinet box.



Paint Grade



The Finishing Touch

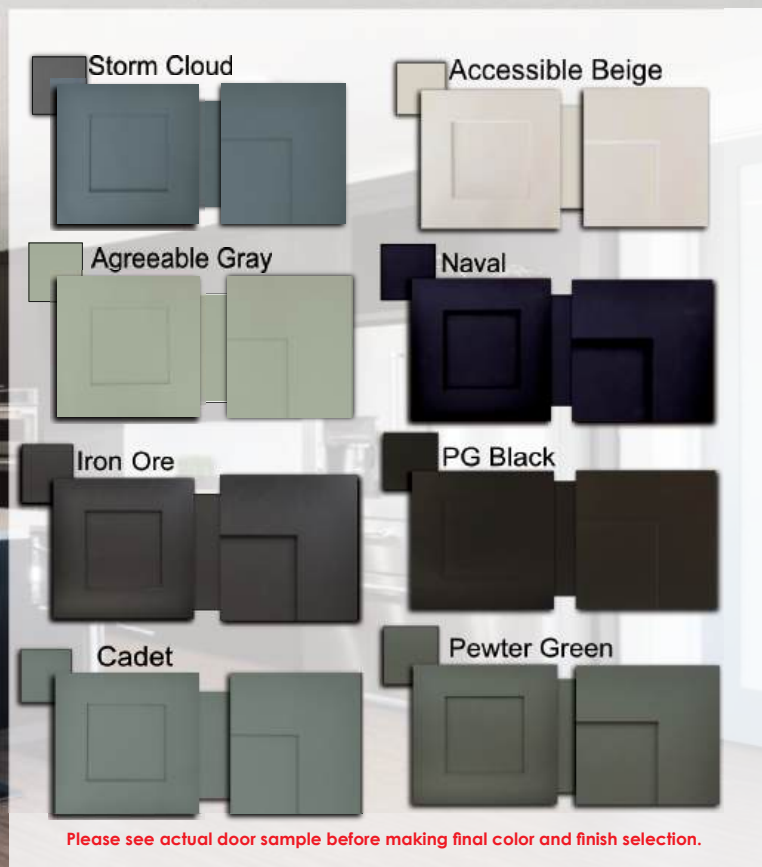

Caution: Climate and other environmental conditions affect the penetration of the glazing compounds. Your cabinets may be lighter or darker, and with more or less grain than samples you selected from. Color shown will vary. **Please see actual door sample before making final color and finish selection.**

Traditional Finish

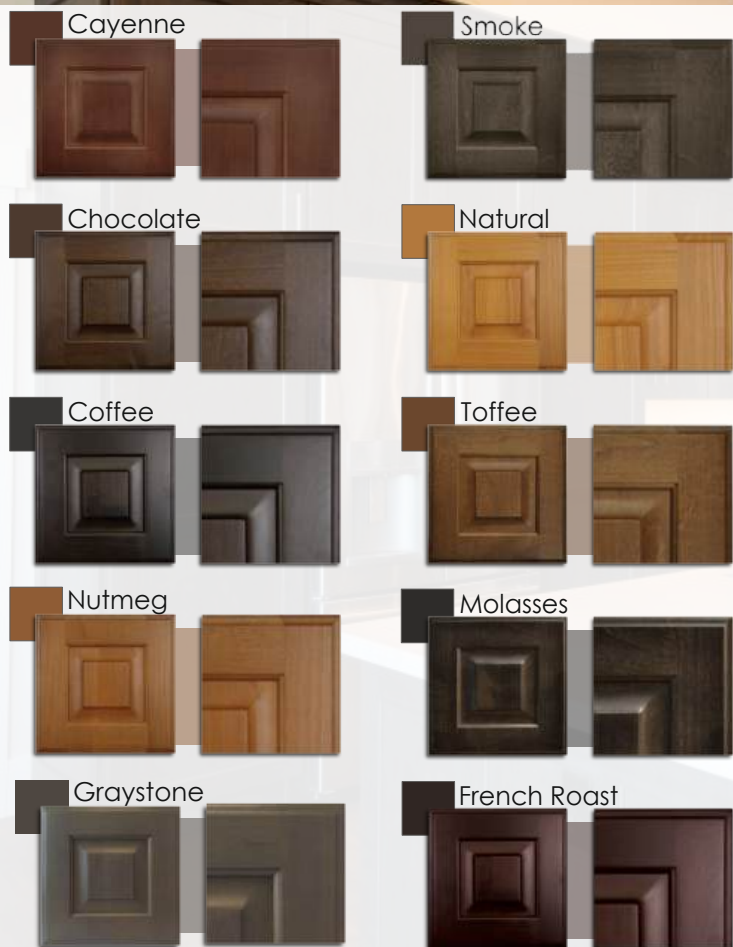

Please see actual door sample before making final color and finish selection.



Tradition is Always in Style



Please see actual door sample before making final color and finish selection.

Caution: Climate and other environmental conditions affect the penetration of the glazing compounds. Your cabinets may be lighter or darker, and with more or less grain than samples you selected from. Please see actual door sample before making final color and finish selection.

Full Body Glaze



Comfort in Color

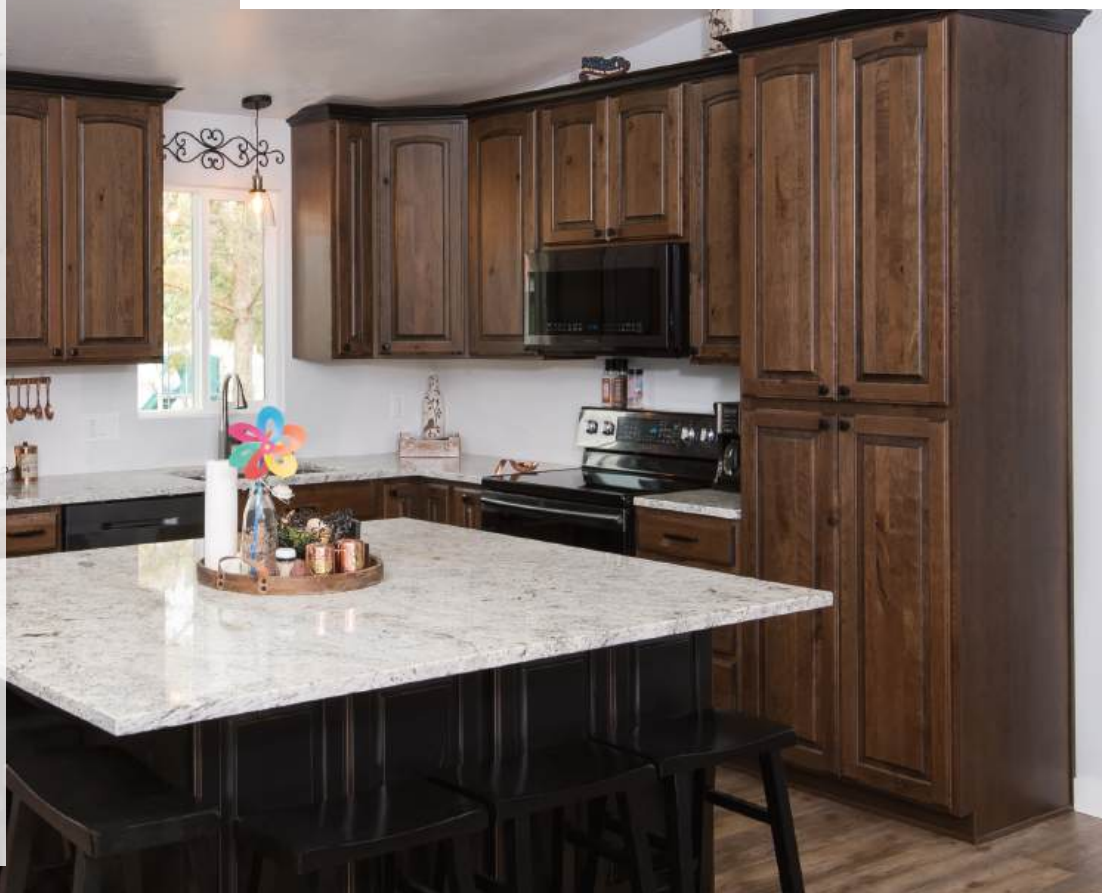

Caution: Climate and other environmental conditions affect the penetration of the glazing compounds. Your cabinets may be lighter or darker, and with more or less grain than samples you selected from. Colors shown will vary. **Please see actual door sample before making final color and finish selection.**

Door Style

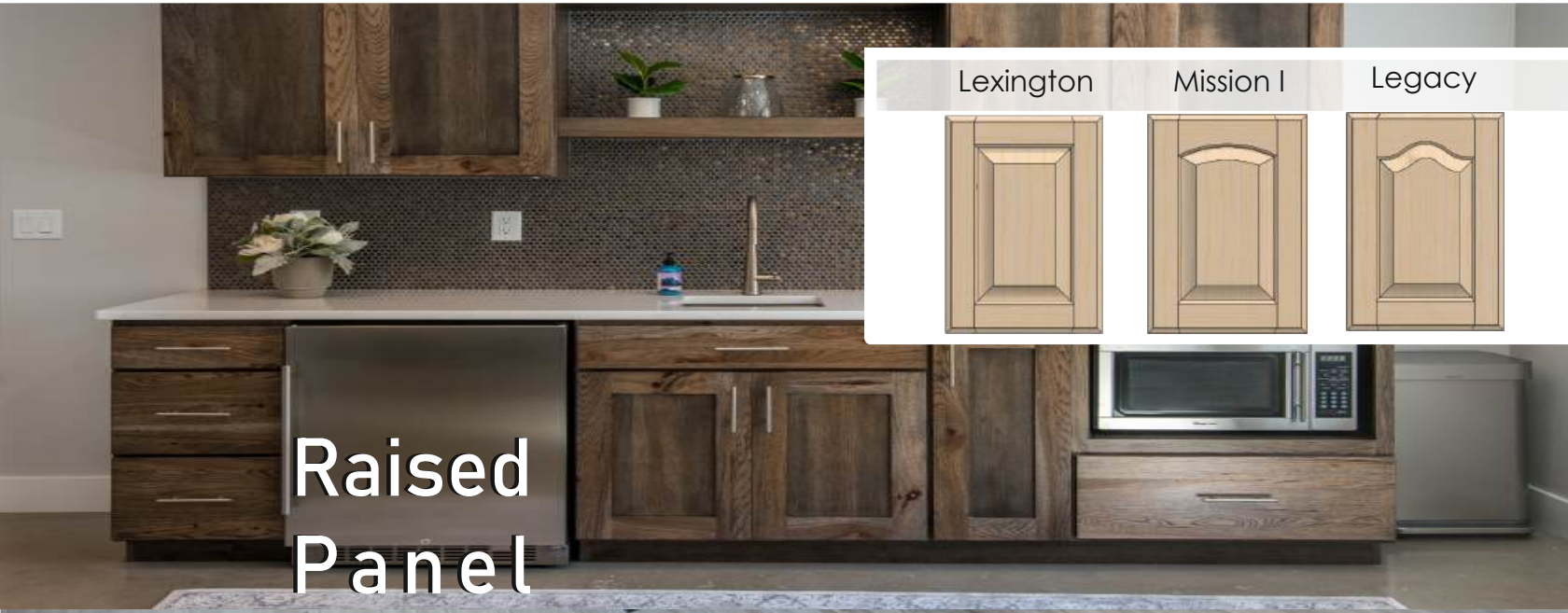

Beauty is in the Details

Recessed Panel



Slab Door

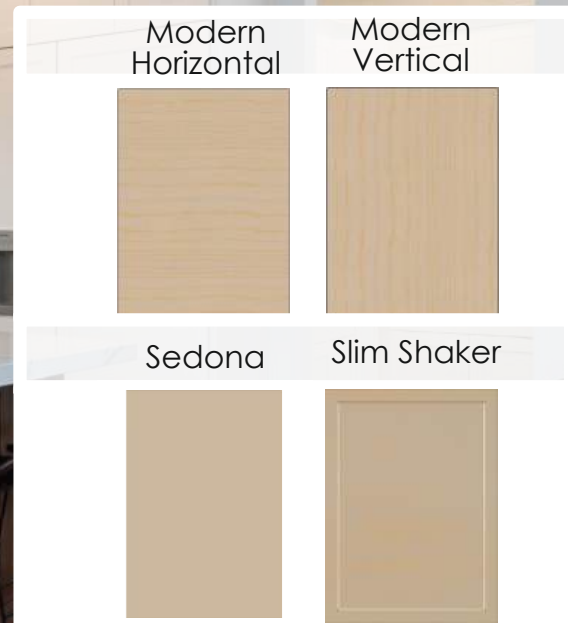

Drawer Boxes And Interior

Your **Dream**
Crafted into
Reality

Plywood Butt Joint

Plywood Dovetail

Hard Wood Dovetail



The **Personal** Touch

Print

White

Plywood

Hardwood



Hardware and Interior

EDGE

EDGE-Hardware by Blum is the perfect fit for any drawer use. The 7/8" extension on this hardware is a great choice for those who want the soft close undermount upgrade to fit the budget.



(100 lb. Load Rating)

TFSC

Tandem is the perfect choice to showcase the fine details of the drawers in your cabinets. Tandem does not fail to impress with its unrivaled running action. Thanks to the integrated Blumotion, now standard on TFSC hardware, drawers will close silently and effortlessly.



(100 lb. Load Rating)

Concealed

Blum hinges are all around adjustable and available with the Blumotion soft close mechanism (see below). With the quality craftsmanship that goes into each one of our cabinets we would use nothing less than the best. Blum hinges have proven to stand the test of time.



Soft Close

The new Blumotion soft close mechanism is integrated in the hinge cup and continues to provide the quality of motion you have come to expect from Blum hardware.



Construction



Quality
Without
Compromise

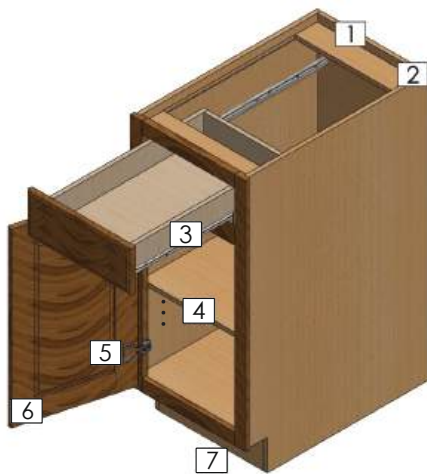

Face Frame Construction

- 1 1/2" Particle Board Box Construction
- 2 1/2" Particle Board Stretcher
- 3 Quality Drawer Guides with a Variety of Options
- 4 3/4" Full Depth Adjustable Shelves
- 5 Multi-Directional Adjustable Concealed Hinges
- 6 3/4" Solid Wood Doors
- 7 Frame and Side Supported Floor

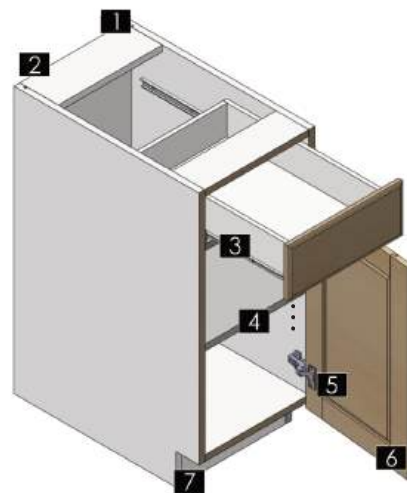

Euro Construction

- 1 3/4" Box Construction with a 1/4" Back with 5-1/8" Nailers
- 2 3/4" Particle Board Stretcher
- 3 Quality Drawer Guides with a Variety of Options
- 4 3/4" Full Depth Adjustable Shelves
- 5 Multi-Directional Adjustable Concealed Hinges
- 6 3/4" Solid Wood Doors
- 7 Tighter Reveal

Why Fashion Cabinet?



Quality... is what we do.

Fashion Cabinet® was established in 1972, and has grown into one of the largest residential and commercial cabinet suppliers in the Intermountain West. Our state of the art manufacturing facility has the latest precision milling and finishing equipment available. From our premium hardwoods and hardware to our top of the line catalyzed conversion varnish finishes. Also, our production employees are provided the very best materials and machinery to manufacture your cabinetry.

Fashion Cabinet® has an exceptional company/employee relationship with one of the lowest turnover rates anywhere. Our craftsmen have many years of cabinetry experience. At Fashion Cabinet® we offer more sizes, options, and custom selections backed by one of the best on-time delivery records in the industry. For the finest craftsmanship in cabinets, furniture, and millwork, specify Fashion Cabinet®.

Service... is why we are here.

Fashion Cabinet® has been locally owned and operated since we opened in 1972. We pride ourselves on our quality and hold ourselves to high standards as an employer and expect the same from our trained workforce. All of the products that we manufacture are made locally by skilled craftsmen that also live in the surrounding areas of our manufacturing facility. Our products are proudly made in the USA.

Made in the USA

We take particular pride in our built to last, made in the USA product.

Dependable Reputation

Having been in the cabinet industry since 1972 we have over 45 years of experience, honesty, and integrity.

Experienced and Professional Sales Staff

Our sales staff, with over 30 years of experience, are also skilled designers.

Experienced Cabinet Installers

We know cabinet installation is an art, so we hire the best installers in the business.

Quality and Craftsmanship

Because we are locally owned and operated we have greater control of the quality in the products we produce.

Huge Selection

Hundreds of finishes, thousands of door style combinations and a dozen wood choices.

Customer Service and Support

With our friendly and knowledgeable customer service you can be confident that we will meet your needs with our local support.

PROUDLY
★★★★★
MADE IN
THE USA



Fashion Cabinet Mfg., Inc.
5440 W Axel Park Road
West Jordan, UT 84081
P: 801.280.0646
F: 801.280.8934
www.fashioncabinet.com